

PROJECT NAME:

PLAN OF PROPOSED (B+G+11) STORIED
RESIDENTIAL CUM COMMERCIAL BUILDING OF MR.
SADHIN GHOSH S/O LATE LAMBODHAR GHOSH MR.
NARAYAN CHANDRA GHOSH S/O LATE ROBI
LOCHON GHOSH MR. MUKTIPADA GHOSH S/O LATE
ROBI LOCHON GHOSH MRS. RINA GHOSH W/O
MUKTIPADA GHOSH MRS. SHOBHA GHOSH W/O
NARAYAN CHANDRA GHOSH MRS. CHHANDA
GHOSH W/O LATE SAROJ GHOSH. R.S PLOT NO-
3,4,6,13 L.R. PLOT NO-13,15,16,83, L.R. KHATIAN
NO- 1589,1805,1845,1955,1956, 2641, J,L. NO
-109 MOUZA-SHANKARPUR, P.S. - N.T.P.S,
DIST-PASCHIM BARDHAMAN, WEST BENGAL.

SCHEDULE OF WINDOW FOR KITCHEN :-

MARK	SIZE	DESCRIPTION
W4	900X1000	SLIDING WINDOW
D/W	900X2100	DOOR CUM WINDOW

SCHEDULE OF DOOR & WINDOW:-

MARK	SIZE	DESCRIPTION
D1	1000X2100	FULLY PNL
D2	900X2100	FULLY PNL
D3	750X2100	FULLY PNL
W	1800X1200	SLIDING WINDOW
W1	1500X1200	SLIDING WINDOW
W2	1200X1200	SLIDING WINDOW
D/W		DOOR CUM WINDOW
R.S		ROLLING SHUTTER
W2 & V3		VENTILATION FOR STAIRCASE
V4	600X450	UPVC MOVABLE VENTILATOR
V5	450X450	UPVC MOVABLE VENTILATOR

*** NOTES :-

1. ALL DIMENSIONS ARE IN mm. ROAD IS IN FT. & INCH. AND ALL LEVEL ARE IN M.
2. WRITTEN DIMENSIONS MUST BE FOLLOWED.
3. ALL EXTERNAL WALLS 250TH. & INTERNAL WALLS 125THK. UNLESS OTHERWISE MENTIONED.
4. ALL MASONRY WORKS ARE BOUNDED BY CEMENT MORTAR (1:6) &(1:4).
5. EXTERNAL PLASTER IS 25THK. & INTERNAL PLASTER IS 12MM.THK.
6. ALL CONC. GRADE IS M25 & AND GRADE OF STEEL FE-500.
7. 250THK. BRICK WORK IN 1:6 MORTAR.
8. 125THK. & 75THK. BRICK WORK IN 1:4 MORTAR.
9. 150 WIDE SURFACE DRAIN SHOULD BE PROVIDED ALL ROUND THE BUILDING.
10. 25% OF THE BUILDING TO BE CONSTRUCTED USING FLY-ASH BRICKS.

AREA CALCULATION:-

LAND AREA	PLINTH AREA	
3268.75 SQ.M	BASEMENT FLOOR	1833.63 SQ.M.
	GROUND FLOOR	1540.23 SQ.M.
	1ST FLOOR	1446.90 SQ.M.
	2ND FLOOR	1446.90 SQ.M.
	3RD FLOOR	1446.90 SQ.M.
	4TH FLOOR	1446.90 SQ.M.
	5TH FLOOR	1446.90 SQ.M.
	6TH FLOOR	1446.90 SQ.M.
	7TH FLOOR	1446.90 SQ.M.
	8TH FLOOR	1446.90 SQ.M.
	9TH FLOOR	1446.90 SQ.M.
	10TH FLOOR	1446.90 SQ.M.
11TH FLOOR	1446.90 SQ.M.	
TOTAL	19289.76 SQ.M.	

* GROUND COVERAGE = 47.11%
* F.A.R = 2.49

SIGNATURE OF DEVELOPER/OWNER:-

Sadhin Ghosh
Chanda Ghosh
Rina Ghosh
Goutam Ghosh
Mukul Ghosh
L.T.E of Manojan Chandra Ghosh by the Pen of Binay Bara

SIGNATURE OF ARCHITECT:-

Manju Monowara Khatun
MANJU MONOWARA KHATUN
ARCHITECT
CA/2022/146222
GIDS, Durgapur -16

DRAWN BY: D.BANERJEE, S.GHOSH.
CHECKED BY: S AKHTAR.
SCALE: 1:100.
REV.-00 DATE:02.09.2022
SHEET NO:-ARCH./P&RD-04/08

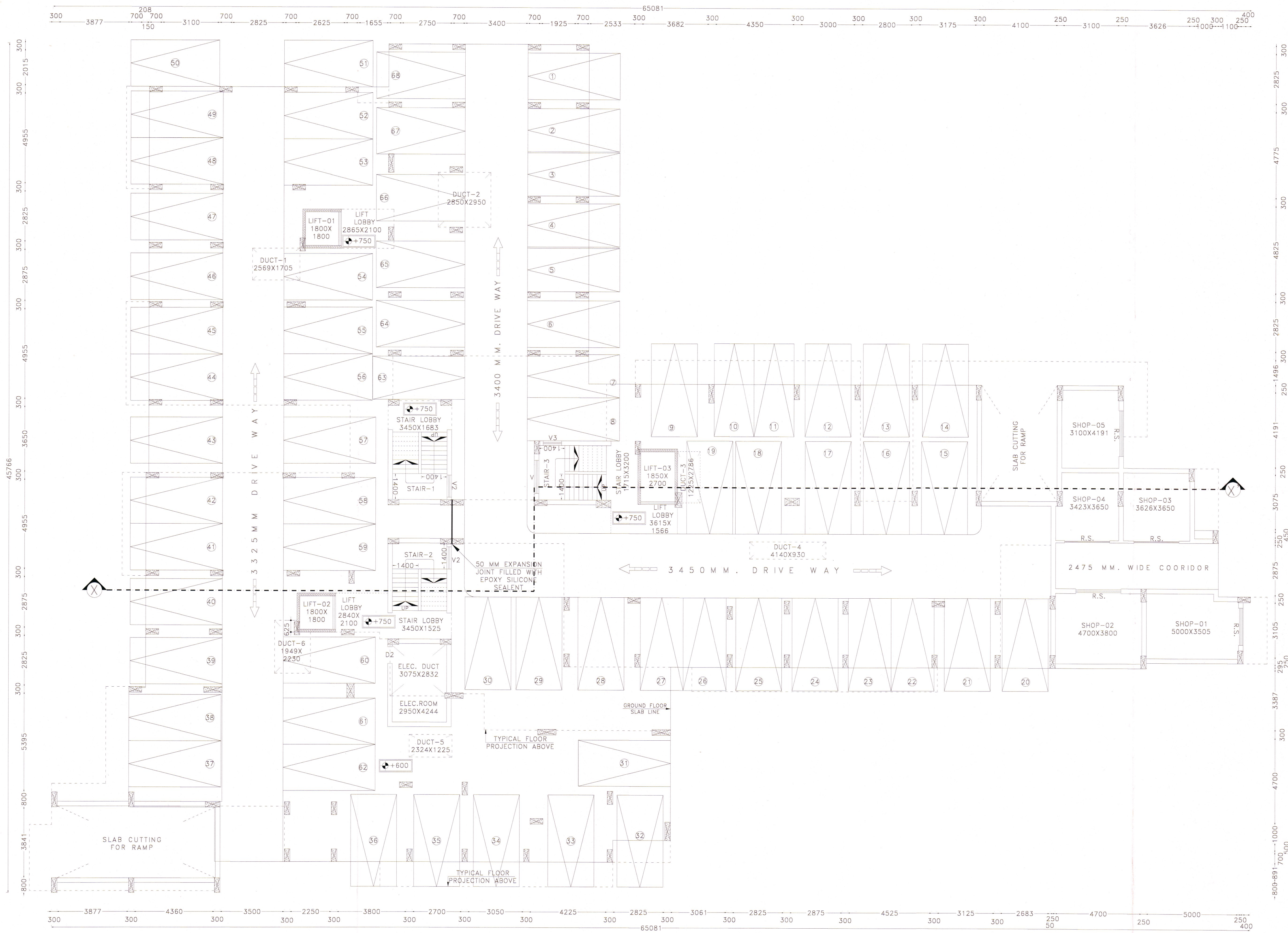

GROUND FLOOR PLAN
SCALE: 1:100

Approved Plan No. 41 on Meeting
No. 18/25-26 Date: 25/11/22
Valid upto: 23/11/27
Saptasati sen
Pradhan
Jemua Gram Panchayat